

Dayton Women's Side

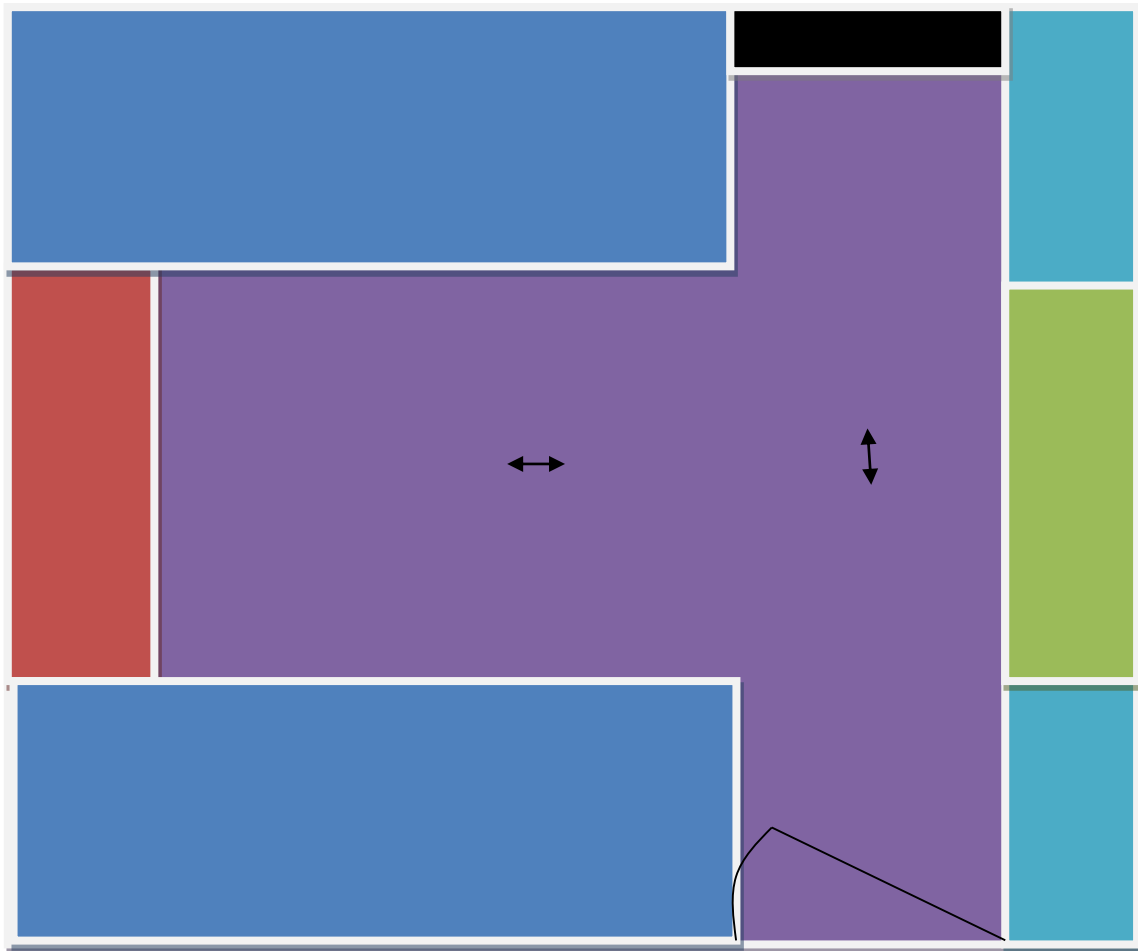

Blue – Beds, red- desk, turquoise- closet/drawers, green- vanity, black- climate control, purple- floor space

- Doorway to climate control unit- 11' 3"      ⇕
- Wall to wall under beds- 11' 11.5"      ⇕
- Under desk to under vanity- 13' 2.5"      ⇔
- Closet/drawers to wall- 11' 7.5"      ⇔

Closet space – Each side of the room has an open closet that is 6' tall, 2' deep, and 1' 10" wide next to four drawers with another closet on top that is 2' deep and 1' 10" wide. That closet and the drawers equal 6' in height. There are 2 more storage compartments, one on top of each closet, that are 1' tall, 1' 10" wide, and 2 feet deep.